

# GRADING PLAN

TOPOGRAPHY SURVEY, SITE & GRADING PLAN  
 PREPARED BY  
**ELEWSKI & ASSOCIATES INC.**  
 7311 VALLEY VIEW DRIVE  
 INDEPENDENCE, OHIO  
 44131

DONALD R. ELEWSKI P.E. 28268

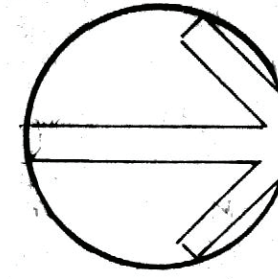
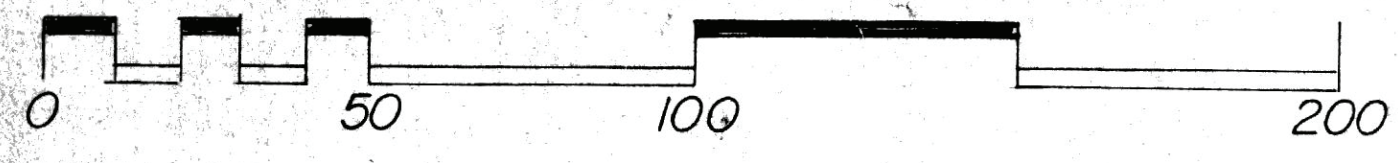
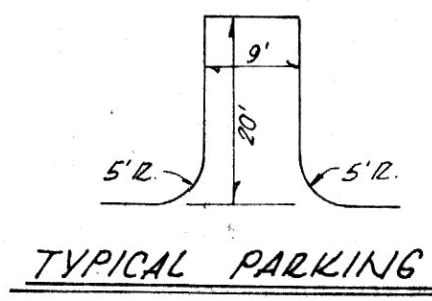

EXISTING CONTOURS  
 DESIGN CONTOURS

EXISTG. ELEV.  
 DESIGN ELEV.

\* DENOTES LIGHTING

STREET LIGHTING  
 NOTE: STREET LIGHTING CONTRACTOR TO EXERCISE  
 CAUTION WHEN INSTALLING POLES AS TO THE  
 EXISTING UNDERGROUND UTILITIES.

TYPICAL STREET LIGHTING

BEACHWOOD LOCAL SCHOOL DISTRICT  
 BOARD OF EDUCATION

BUILDING 3

BUILDING 4

BUILDING 1

BUILDING 2

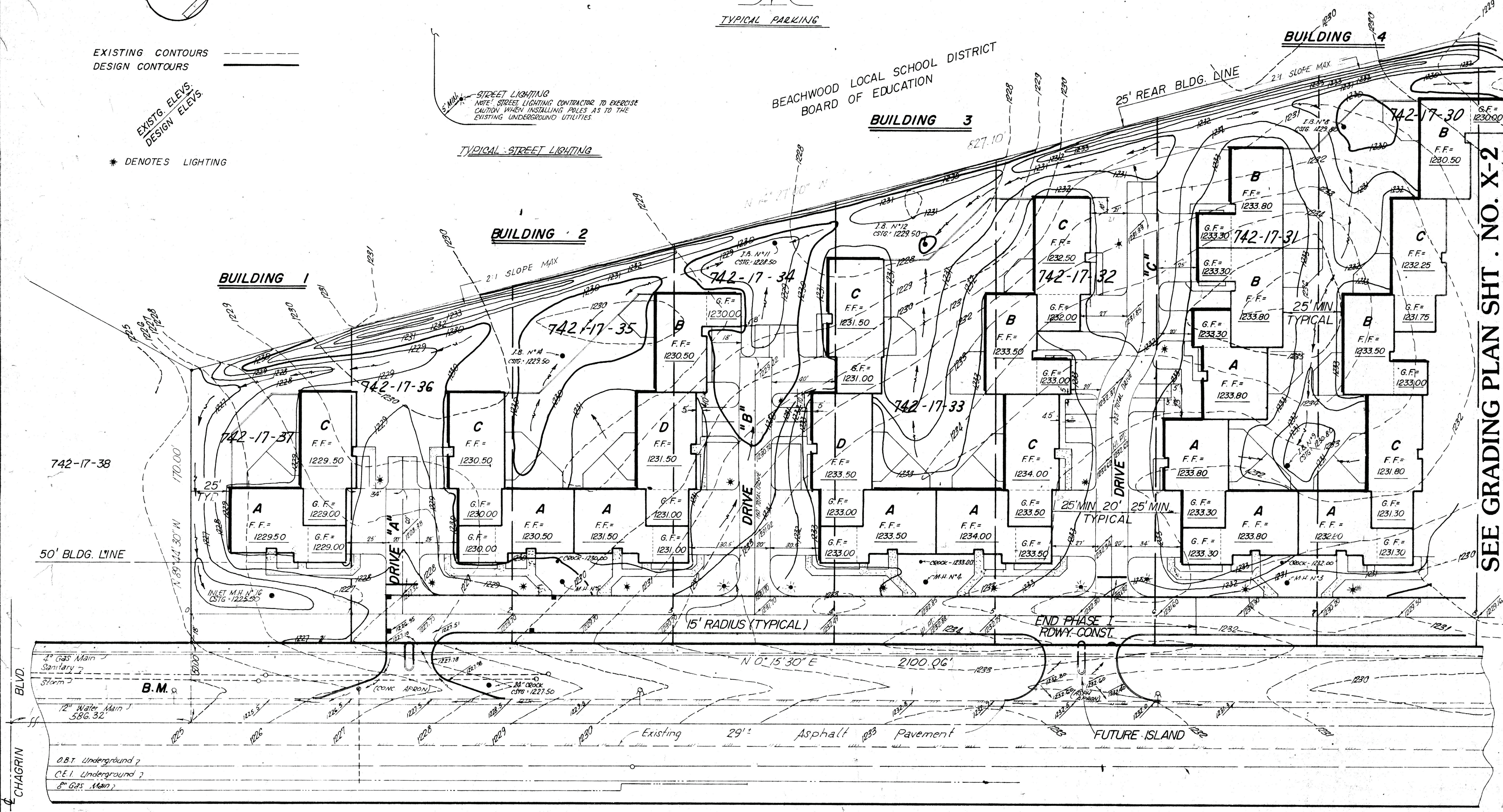

BLVD  
 CHAGRIN

1" Gas Main  
 Sanitary  
 Storm

12" Water Main  
 586.32'

0.87' Underground  
 C.E.I. Underground  
 8" Gas Main

RICHMOND ROAD 100'

NOTE: CONTACT COUNTY SANITARY ENGINEER'S OFFICE REGARDING PERMITS AND INSPECTION OF EXTERIOR SEWERS

"B.M."  
 TOP OF HYDRANT  
 ELEV. = 1227.09

SEE GRADING PLAN SHT. NO. X-2

KEEVA J. KEKST ASSOCIATES ARCHITECTS INC.

RICHMOND ROAD CONDOMINIUMS  
 RICHMOND ROAD BEACHWOOD, OHIO  
 CONDOMINIUM CONCEPTS INC. CLEVELAND, OHIO

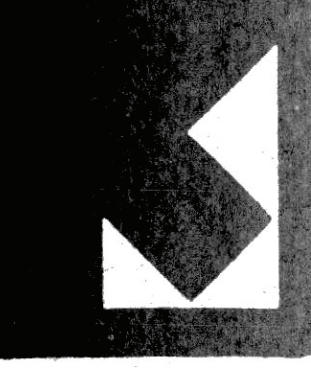

GRADING PLAN

DWN BY RAY  
 DATE 4/25/83  
 JOB NO. E-423

X-1

Plans Revis. As Per City Engineer 5/12/83

TOPOGRAPHY SURVEY, SITE & GRADING PLAN  
 PREPARED BY  
**ELEWSKI & ASSOCIATES INC.**  
 7311 VALLEY VIEW DRIVE  
 INDEPENDENCE, OHIO  
 44131

DONALD R. ELEWSKI P.E. 28268

**GRADING PLAN**

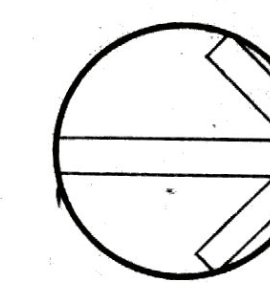
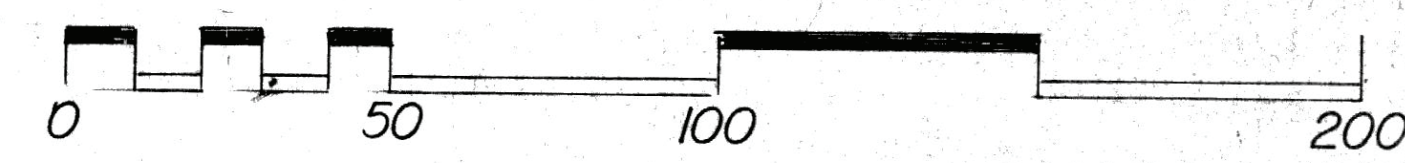

EXISTING CONTOURS  
 DESIGN CONTOURS  
 EXIST'G ELEV'S.  
 DESIGN ELEV'S.  
 \* DENOTES LIGHTING

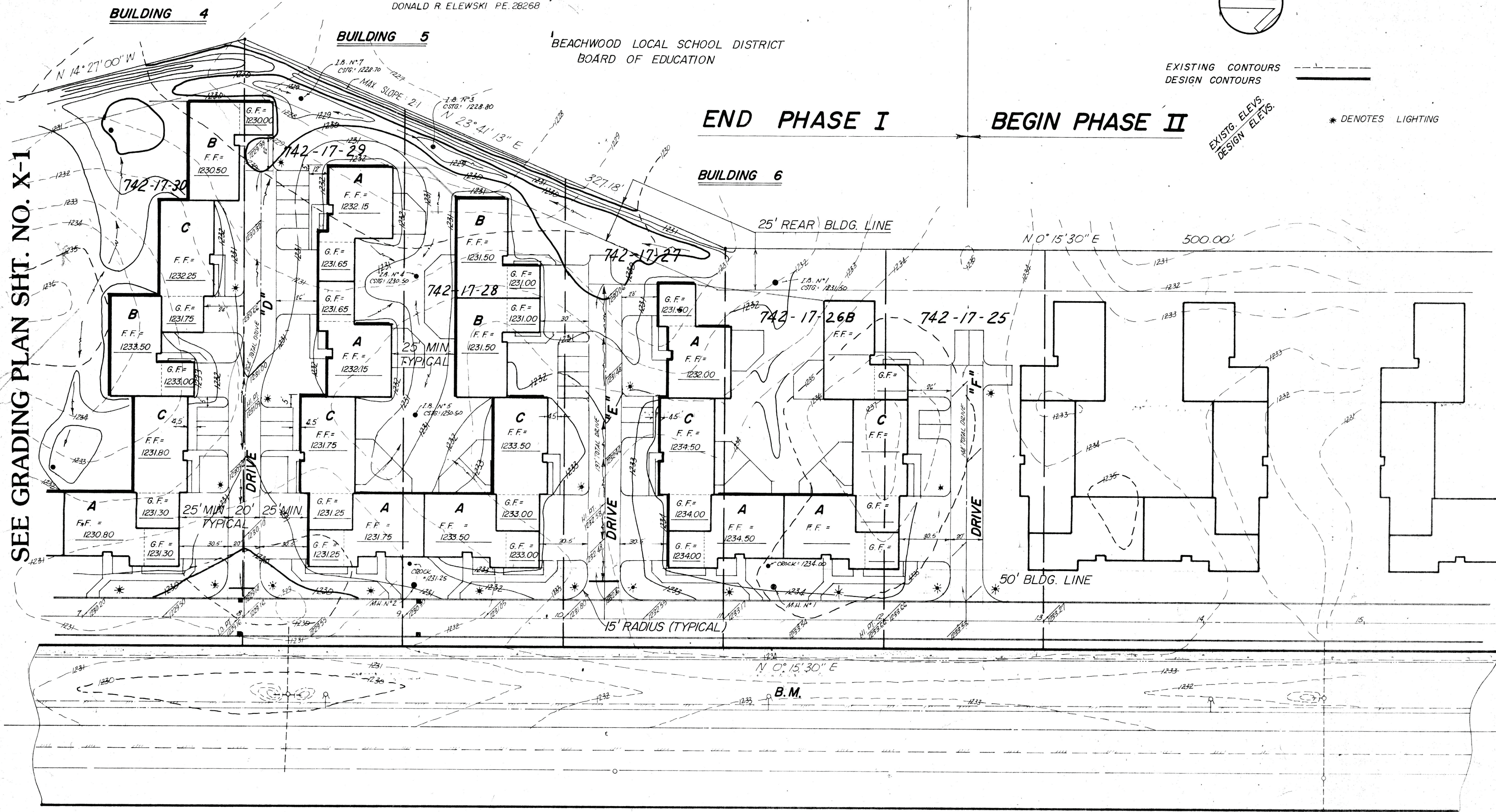

SEE GRADING PLAN SHT. NO. X-1

**RICHMOND ROAD 100'**

"B.M."  
 TOP OF HYDRANT  
 ELEV. = 1235.91

**KEEVA J. KEKST ASSOCIATES ARCHITECTS INC.**

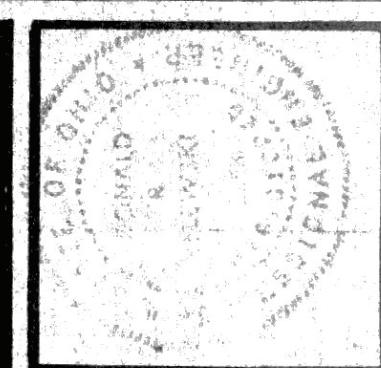

**RICHMOND ROAD CONDOMINIUMS**  
 RICHMOND ROAD BEACHWOOD, OHIO  
 FOR  
**CONDOMINIUM CONCEPTS INC.**  
 CLEVELAND OHIO

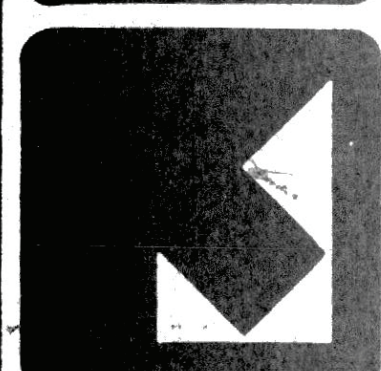
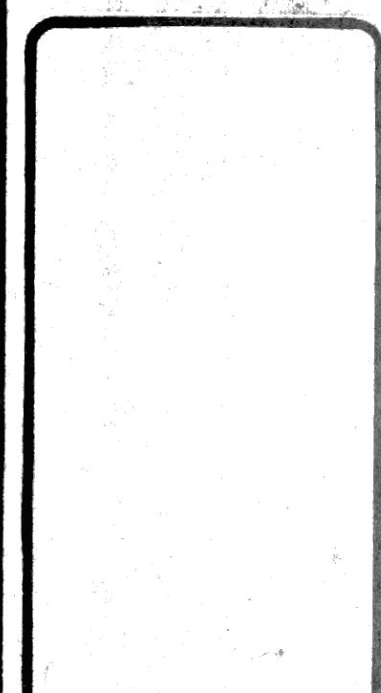

**GRADING PLAN**

OWN BY RAY  
 DATE 4/25/83  
 JOB NO. E-423

**X-2**